

# **LOBO ASA Ranch Trial August 23<sup>rd</sup> 2014**

**Judge (Steve Shope)**

Course Director Phillip Blackshear/Bob Myrick7707576033

Location: Free to Be Ranch Mountainair, NM -owner Geri Abrams

**This Trial is being offered on cattle and sheep. There will be 8 cattle runs and 12 sheep runs available. Entries open July 7<sup>th</sup>. Pre entries close August 4<sup>th</sup>. This trial is not recommended for physically challenged individuals.**

**There is a lot of real estate to cover to complete this trial. A horse or 4 wheeler can be used if desired, but you will need to bring your own. If used to push cattle, your score will reflect that. We are requesting a 30 minute time limit due to distance cattle must go. Sheep time limit will be 20 minutes.**

**PreEntries Sheep \$45, cattle \$55 Day of if available \$55, \$65**

NO PRE-ENTRIES ACCEPTED PRIOR TO A POSTMARK DATE OF July 7th, 2014.

PRE-ENTRIES MUST BE POSTMARKED BY August 4th, 2014 – Entries must have clearly visible USPS postmark. No meter mail allowed. No DHL. UPS, telephone, email, faxed entries will be accepted. Overnight entries accepted only if signature is waived. Incomplete entry forms including registration numbers and entries will NOT be accepted. Please make sure your entry form includes the dog's call name and your e-mail address. Registered owner of dog must submit entry check with their name on the check & send a copy of the dogs registration/tracking # form showing registered owner with the entry form. Checks will be deposited on August 5th. Insufficient funded checks will be charged a \$50. Fee, and runs granted to next contestant on waiting list.

Day of entries accepted (if available) until 7:30 am when Handlers Meeting Starts

Mail Entries to: Bob Myrick, 16 Camino DE FE, Moriarty NM, 87035

Prizes: Rosettes will be awarded for 1<sup>st</sup> thru 4<sup>th</sup> place.

## DRIVING DIRECTIONS TO FREE TO BE RANCH

Mountainair is located 60 miles south east of Albuquerque. The ranch is 30 minutes from either Interstate 40 or from Interstate 25. The ranch is 1/2 mile off Hwy 60 on Curandera Road - Curandera Road is between mile marker 208 & 209 on Hwy 60.

### **DIRECTIONS FROM INTERSTATE 40 IN NEW MEXICO:**

- Take exit 196 in Moriarty, go south on Hwy 41 until it dead ends into Hwy 60
- Take a right (west) onto Hwy 60 - go approximately 7 miles on Hwy 60
- On Hwy 60 go 1/2 mile past mile marker 209 to County Road BO 46
- Turn right (North) onto County Road BO 46 - We are the first ranch on your left

### **DIRECTIONS FROM INTERSTATE 25 IN NEW MEXICO:**

- Take Exit 175 in Bernardo, go east on Hwy 60
- Go thru blinking light in the town of Mountainair (we are about 4 1/2 miles from the light)
- On Hwy 60 go 1/2 mile past mile marker 208 to County Road BO 46
- Turn left (North) onto County Road BO 46 - we are the first ranch on your left

### **Accommodations:**

## FREE TO BE RANCH RV FACILITIES

### **RV HOOKUPS - ELECTRIC AND FREE WATER**

- LIMITED AVAILABILITY BY RESERVATION ONLY - DEPOSIT REQUIRED
- 30 AMP CHARGE IS \$25 PER NITE - 50 AMP CHARGE IS \$30 PER NITE  
*Send your request for a RV Hookup for ANY trial held at Free To Be Ranch with your trial entry. Include with your request a separate check made out to LOBO ASA for entire stay which is not refundable after entry close date.*

**DRY CAMPING - PARKING SPOTS WILL BE ASSIGNED BASED ON AVAILABILITY. DOES NOT INCLUDE ANY SERVICES WATER MAY BE PURCHASED FOR \$5.00 A FILL UP**

**NO DUMPING OF RV TANKS IS ALLOWED ON RANCH PROPERTY DUE TO ENVIRONMENTAL CONCERNS. *There is a public dumping facility at the Turner Inn and RV Park in Mountainair.***

NEARBY RV AND MOTEL FACILITIES **MOUNTAINAIR, NM - about 10 minutes from the ranch**

- **Turner Inn and RV Park:** 303 E Highway 60, Mountainair, NM 87036, 1-505-847-0248 or email at [reservations@turnerinnandrmpark.com](mailto:reservations@turnerinnandrmpark.com)

Mountainair has 3 restaurants, Grocery Store, Gas Station, Pharmacy, Post Office, Auto Repair Shop and Art Galleries. It is an old fashioned small town.

**MORIARTY, NM - about 45 minutes from the ranch**

**Comfort Inn:** 119 Route 66 East , Moriarty, NM - (505) 832-6666

- **Days Inn:** PO Box 367, 1809 West Rte. 66, Moriarty, NM - (505) 832-4451
- **Econo Lodge:** 1316 Route 66 West , Moriarty, NM, 505-832-4457
- **Holiday Inn Express:** 1507 Route 66, Moriarty, NM - (505) 832-5000
- **Super 8:** PO Box 1127, 1611 West Old Route 66, Moriarty, NM - (505) 832-6730

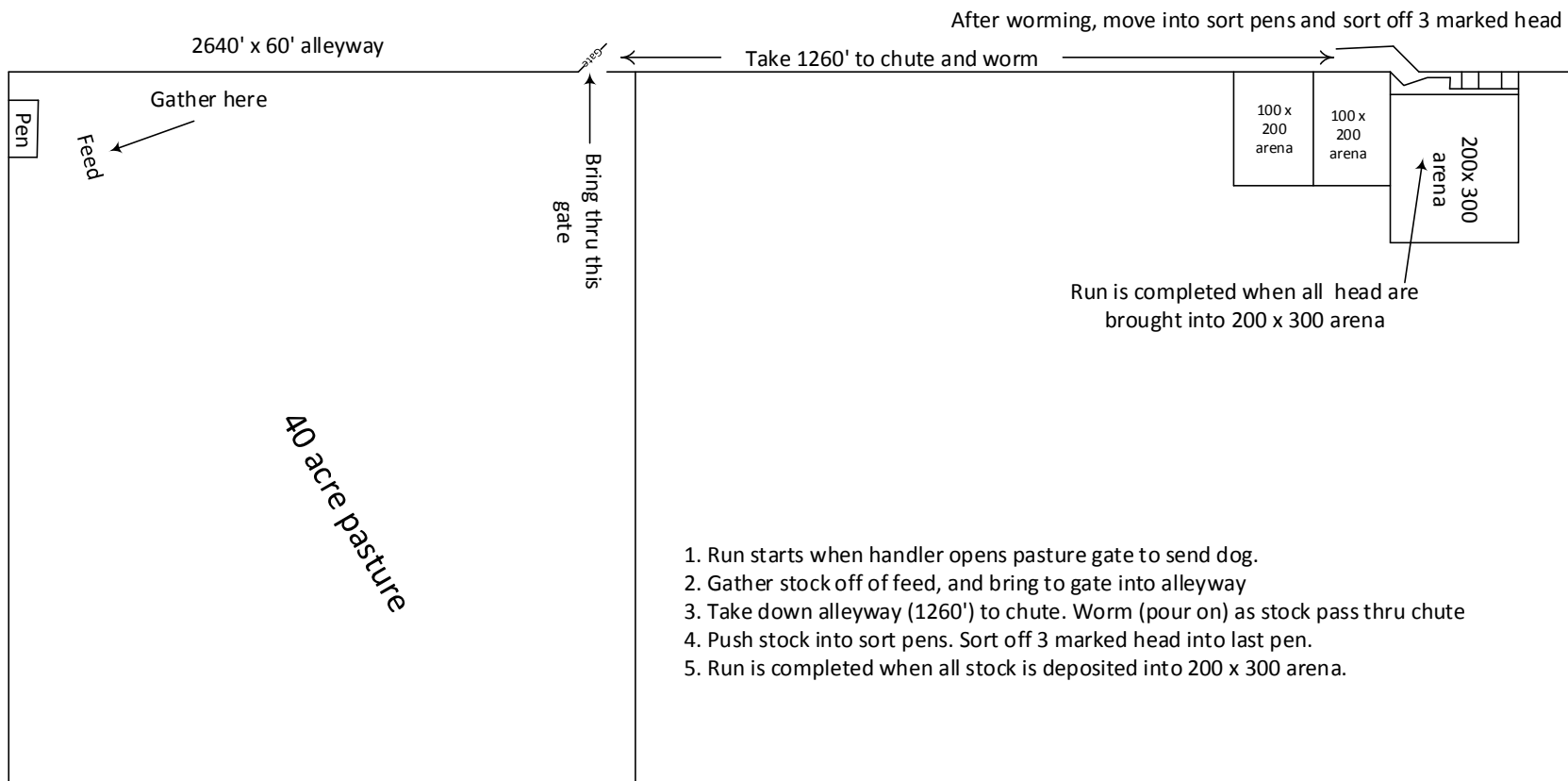

1. Run starts when handler opens pasture gate to send dog.
2. Gather stock off of feed, and bring to gate into alleyway
3. Take down alleyway (1260') to chute. Worm (pour on) as stock pass thru chute
4. Push stock into sort pens. Sort off 3 marked head into last pen.
5. Run is completed when all stock is deposited into 200 x 300 arena.

# LOBO ASA Ranch Trial 2014

## cattle

Alleyway from pasture

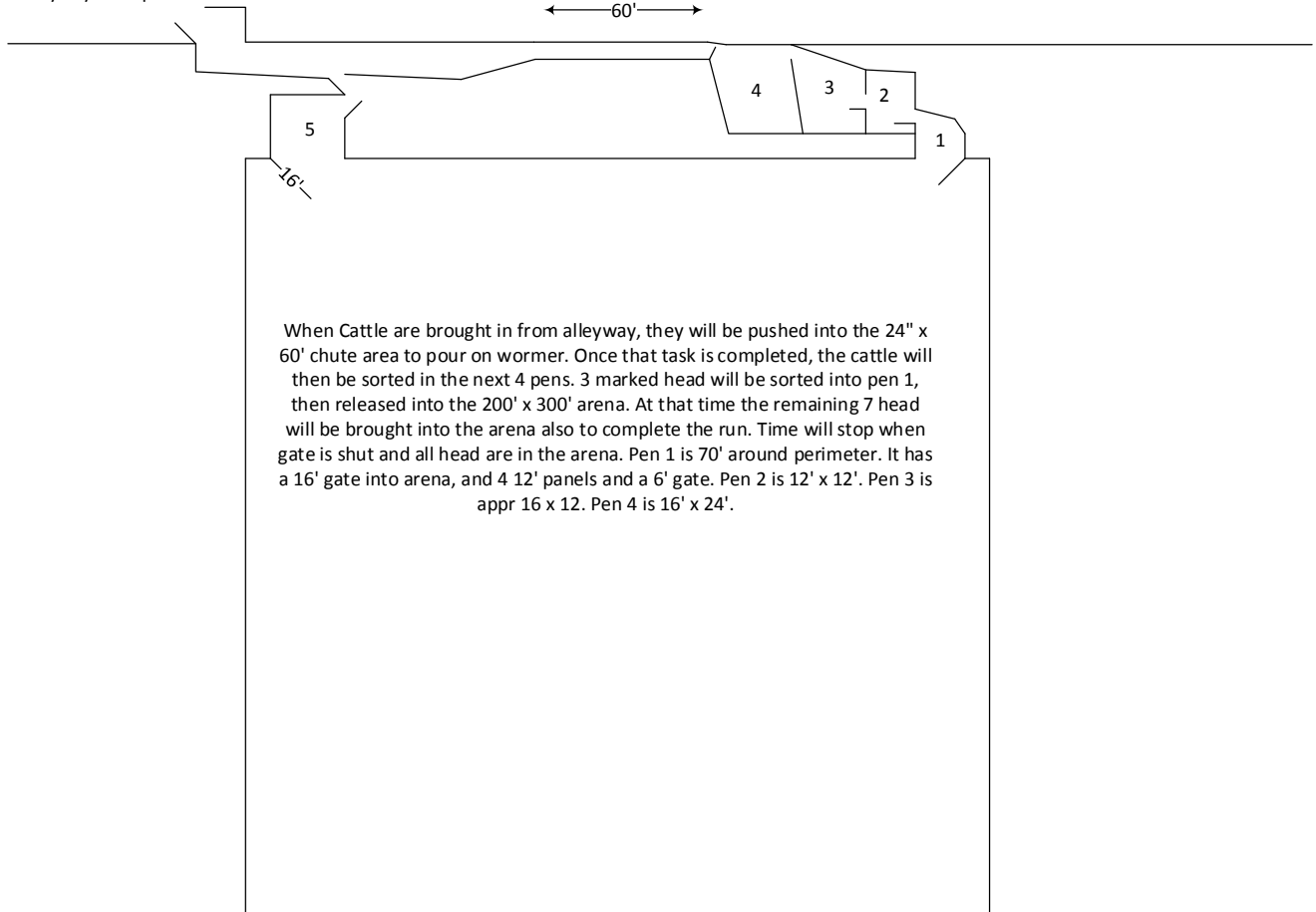

When Cattle are brought in from alleyway, they will be pushed into the 24" x 60' chute area to pour on wormer. Once that task is completed, the cattle will then be sorted in the next 4 pens. 3 marked head will be sorted into pen 1, then released into the 200' x 300' arena. At that time the remaining 7 head will be brought into the arena also to complete the run. Time will stop when gate is shut and all head are in the arena. Pen 1 is 70' around perimeter. It has a 16' gate into arena, and 4 12' panels and a 6' gate. Pen 2 is 12' x 12'. Pen 3 is appr 16 x 12. Pen 4 is 16' x 24'.

# Sheep

NORTH

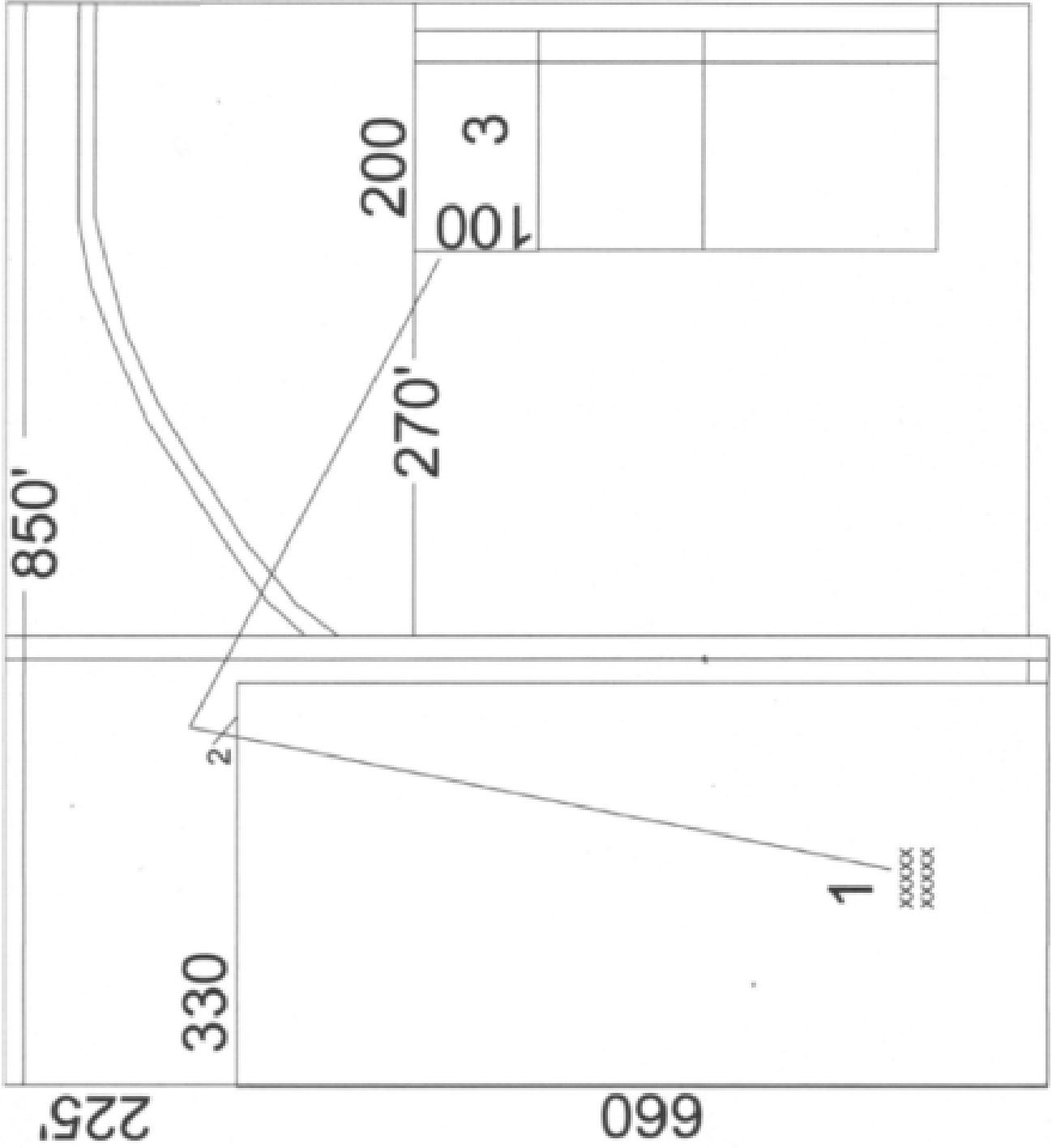

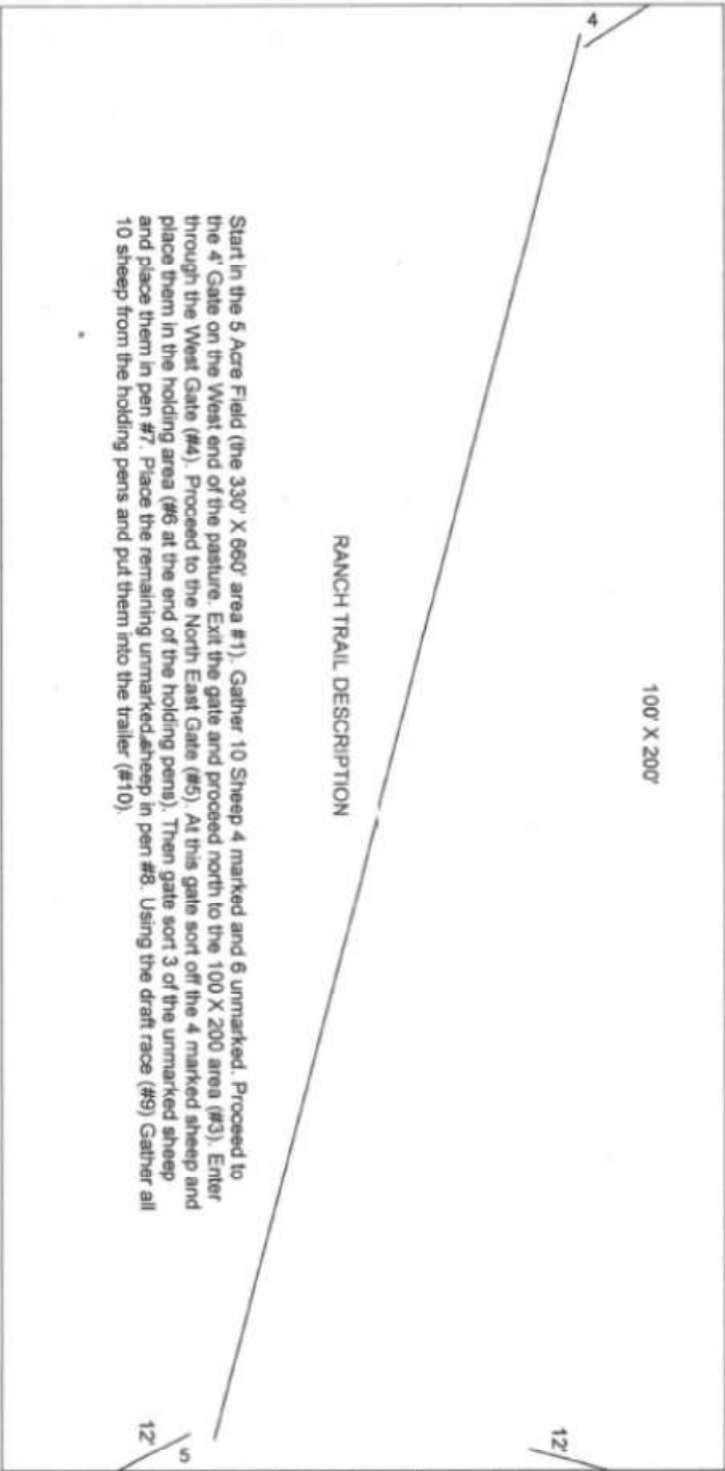

RANCH TRAIL DESCRIPTION

Start in the 5 Acre Field (the 330' X 660' area #1). Gather 10 Sheep 4 marked and 6 unmarked. Proceed to the 4' Gate on the West end of the pasture. Exit the gate and proceed north to the 100 X 200 area (#3). Enter through the West Gate (#4). Proceed to the North East Gate (#5). At this gate sort off the 4 marked sheep and place them in the holding area (#6 at the end of the holding pens). Then gate sort 3 of the unmarked sheep and place them in pen #7. Place the remaining unmarked sheep in pen #8. Using the draft race (#9) Gather all 10 sheep from the holding pens and put them into the trailer (#10).

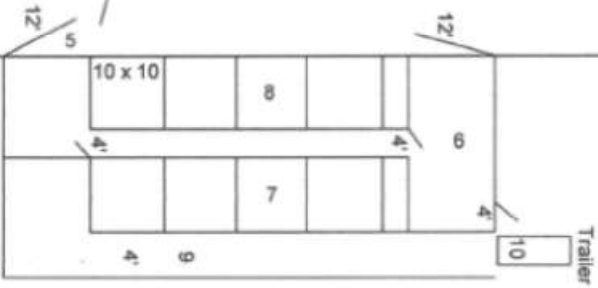

NORTH